



Glacier Hinged Shower System

SFK-GL-HR



Plumbers, please ensure a copy of the Installation Instructions are left with the end user for future reference.





Glacier Hinged Shower System

HINGING SCREEN FITTING INSTRUCTIONS – HR

Components:

- 1 x **Bag 1** – Allen Keys
- 1 x **Bag 11** - Packers
- 1 x Clear Silicon
- 1 x Handles Set **E-500**
- 2 x Hinges adjustable – STD
- 1 x Screen Fitting Instructions

Other equipment required:

- Caulking Gun
- Drill
- Level
- Pencil
- Tape Measure
- Knife

Checked by: _____

Date: _____

Included in this package:

- | | |
|----------------------------------------------------------------------------------------------------------|-------------------------------------------------------------------|
| 1 x Glass Door with 2 Cutouts A <input type="checkbox"/> | 2 x Glass Receiver Channels – WCT <input type="checkbox"/> |
| 1 x Glass Return Panel B <input type="checkbox"/> | 1 x Below components included in WCT |
| 1 x Fixed Panel with 2 Cutouts C <input type="checkbox"/> | 8x6Gx40 Sq drive screws & wall plugs – <input type="checkbox"/> |
| Metal Top Brace - AU-MTB (not supplied on 3 wall showers 1000mm or less) <input type="checkbox"/> | 1x4mm drill bit <input type="checkbox"/> |
| | 2 x Edge Seal (optional) <input type="checkbox"/> |
| | 1 x Clear Bottom Seal - Standard <input type="checkbox"/> |

ATLANTIS RECOMMENDS DRYFITTING COMPONENTS PRIOR TO INSTALLATION TO ENSURE CORRECT PLACEMENT

PLEASE NOTE: Stand glass upright at all times. Keep glass panels level with the floor to avoid damaging corners.

If a protective cover is adhered to Base it should be left in place until frameless screen installation is complete.

NO RESPONSIBILITY WILL BE TAKEN BY ATLANTIS FOR ANY GLASS BREAKAGES OR CHIPPED EDGES.



Glacier Hinged Shower System

**GLASS RECEIVER CHANNEL MUST BE
INSTALLED ONTO THE WATERPROOFING
BEFORE THE WALLS ARE TILED**

INSTRUCTIONS FOR 2 WALL SYSTEM

1. Choose door location.

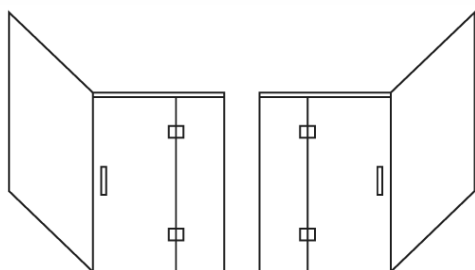

2. Position the glass receiver channels over the base glazing channels. Mark the wall to indicate where the wall channels are plumb.

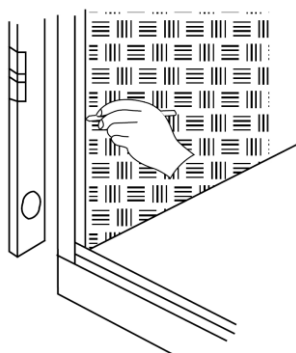

3. Mask two sides of wall channel before applying white silicon. Apply a continuous 8mm bead of white silicon to full length of wall channels in groove as indicated.

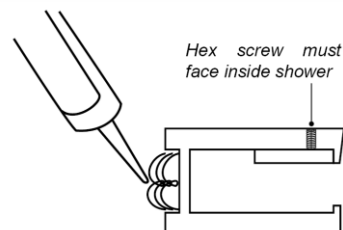

4. Ensure the glass receiver channels are located firmly over the base glazing channels. Locate the framing timber. Use the 4mm drill bit to drill holes through the glass receiver channels. Fix four screws through the channels into the wall framing (use wall plugs if required supplied with wall channels).

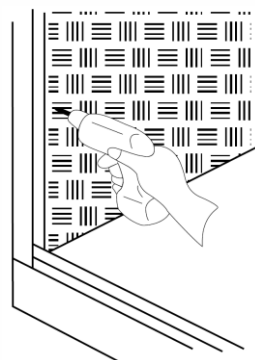

Apply a 10mm continuous bead of Sika Artic White silicon, to the full length of each wall channel. Silicon seal the joint where the wall and base channel will intersect.



Glacier Hinged Shower System

TILED WALLS - apply an additional bead of silicon to the inside of the waterproofing

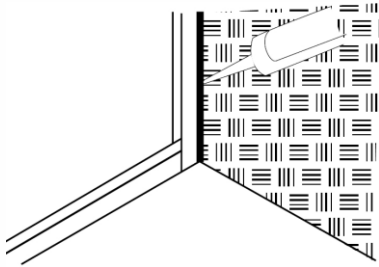

ELLURE WALLS / ACRYLIC LINER - apply an additional bead of silicon to the outside of the acrylic liner/Ellure Walls.

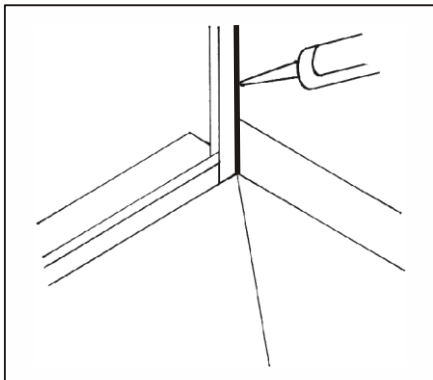

GLASS INSTALLATION

Keep glass standing upright. Once package containing glass is opened, check glass is facing same direction up as label, do not sit glass directly on floor, always sit glass on polystyrene packaging or similar padded surface. Keep glass level with floor to avoid hitting corners on hard surfaces.

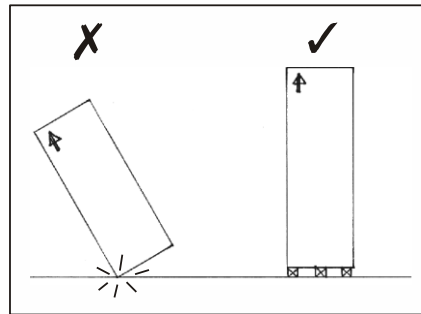

5. THIS STEP ONLY APPLIES IF ACRYLIC LINER HAS BEEN SUPPLIED.

Fix liner cover to wall channel covering exposed liner edge as shown.

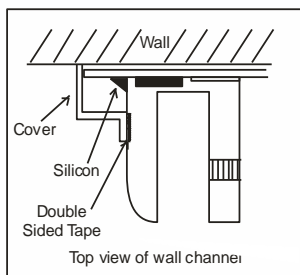

6. PREPARATION FOR GLASS INSTALLATION

Slide the sill infill into position and apply 6mm plastic packers (**BAG 11**) into the base glazing channels in locations as shown.

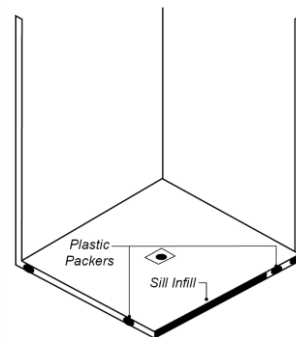



Glacier Hinged Shower System

7. CRITICAL SEAL



Remove the dust and dirt first. Seal the connection between the glass receiver channel and the base glazing channel with clear silicon, prior to the installation of panel **B** and **C**. Ensure junction between wall channel and base channel is full of silicon before final glass placement.

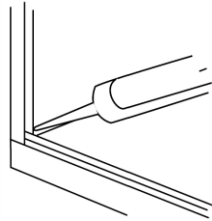

8. INSTALLATION OF RETURN PANEL

Locate panel **B** into the glazing channels. The top of panel **B** must be level with the top of the opposite glass receiver channel. Adjust the height of the panel if necessary by adding or removing the plastic packers in the base glazing channel.

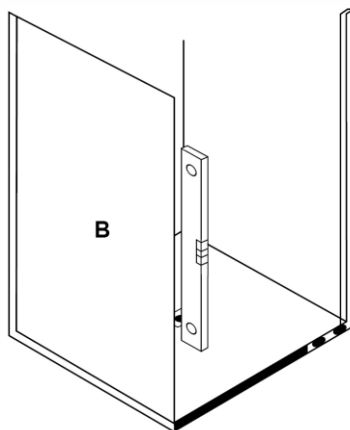

9. INSTALLATION OF FIXED PANEL

Locate panel **C** into the glazing channels. The top of panel **B** must be level with the top of panel **C**. Adjust the height of the panel if necessary by adding or removing the plastic packers in the base glazing channel.

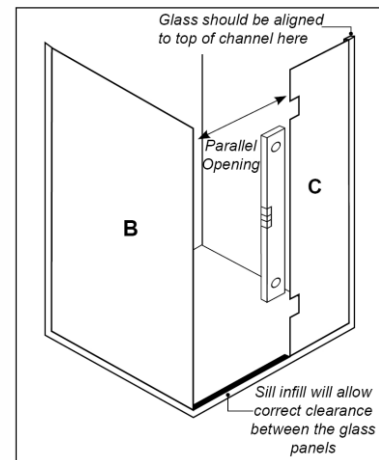

10. SILL INFILL

Apply a continuous bead of clear silicon to each inside face of the base channel. Ensure the ends of the infill are sealed and place into the base channel in the location as shown.

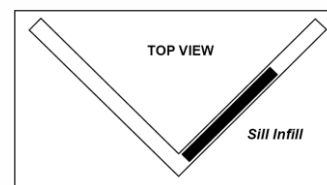



Glacier Hinged Shower System

11. FASTENING GLASS

Secure the glass panels into the receiver channels by tightening hex key screws firmly with hex key supplied. **DO NOT OVERTIGHTEN.**

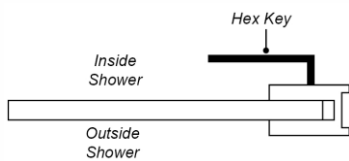

12. PROTECTION OF GLASS EDGE

Apply 1mm plastic packer to the edge of glass with the masking tape as shown. Position one next to each hinge cut out.

This will ensure correct door clearance and prevent glass damage.

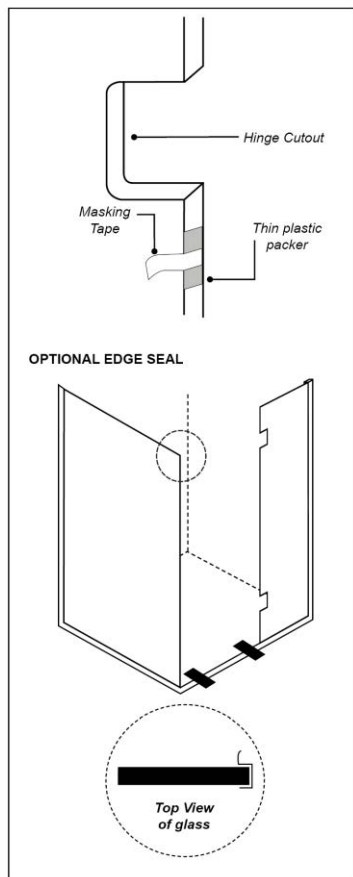

13. CLEARANCE UNDER DOOR

Place 6mm Spacers over the door infill before the installation of the glass door.

14. HINGE INSTALLATION

Atlantis glass is now coated with CristalCote glass protection at the factory. This coating may cause the hinge to slip after installation. Atlantis recommends cleaning around the hinge cut out prior to fitting hinges. Clean both sides of the glass 15mm around the edge of the cut out with Fuelite (fuellite is available from petrol stations). Alternatively, the area can be lightly sanded with 300grit sandpaper.

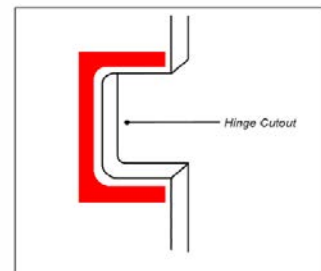

ADJUSTABLE HINGES

Atlantis showers are now supplied with adjustable hinges

COVER PLATE REMOVAL

Remove the cover plate by loosening the small grub screws on the edge of the hinge cover using a 1.5mm hex key. Loosen the bolts with 4mm hex key. Fit the hinges, the removable cover must be on the outside of the shower.

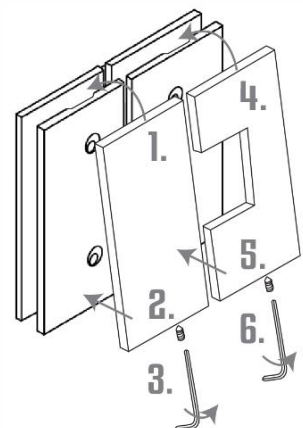



Glacier Hinged Shower System

15. DOOR INSTALLATION

Hinges should be in the closed position (in line) before attempt in to install the glass door.

Slide the door into the hinges. Centre the door between the side panels and tighten the hinge bolts firmly with the 4mm hex key supplied.

ENSURE HINGES ARE CLEAR FROM SIDES OF GLASS CUTOUTS AND HINGE BOLTS ARE FINALLY TIGHTENED AS MUCH AS POSSIBLE.

VIEW FROM INSIDE SHOWER

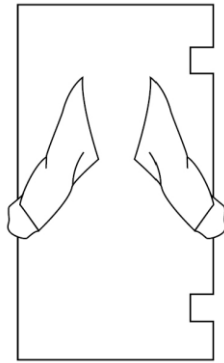

REFIT COVER PLATE

Place the cover plate over the hinge body as shown. Refit cover plate with a 1.5mm hex key.

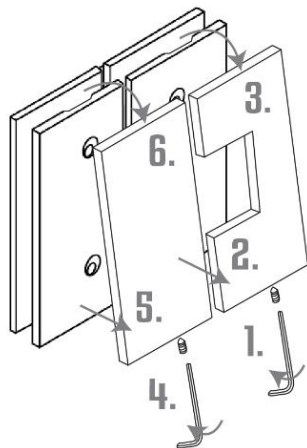

DOOR REALIGNMENT

Use 3mm hex key to loosen the cap screws near the, align the door to desired position and then re-tighten.

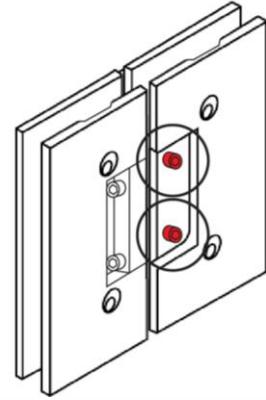

16. DOOR

CLEARANCE

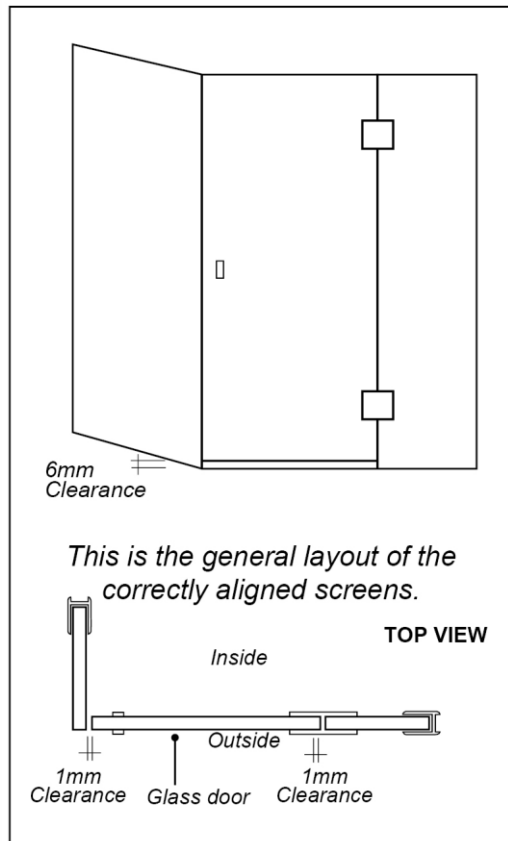



Glacier Hinged Shower System

17. HANDLE INSTALLATION

Assemble the handles as shown.

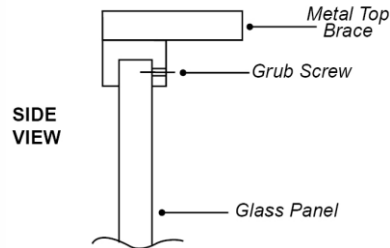
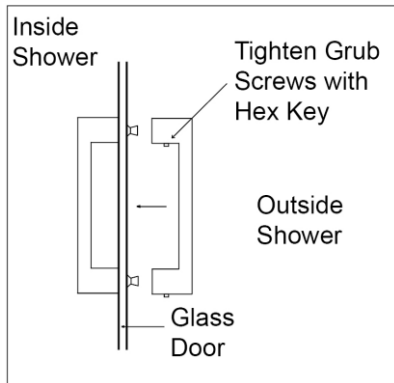

2 Wall LH Screen

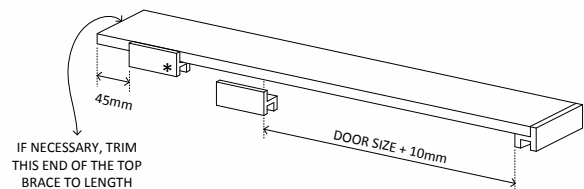

18. METAL TOP BRACE INSTALLATION

Place the Top Brace onto the fixed glass panels in the position as shown. Lightly tighten grub screws. (**BAG-AU-MTB**) onto the glass panels.

Fit 2,3 or 4 top brace blocks to the top brace bar at your discretion. Atlantis suggests that two top brace blocks are fitted for any panel measuring wider than 230mm.

Lightly tighten the grub screws

2 Wall RH Screen

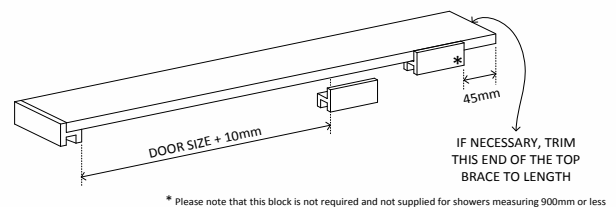

* Please note that this block is not required and not supplied for showers measuring 900mm or less

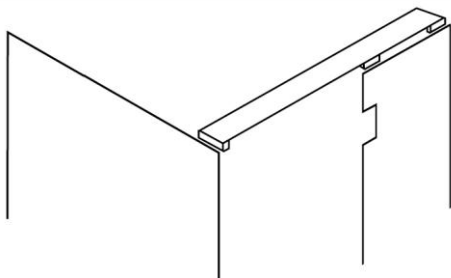



Glacier Hinged Shower System

19. SILICON APPLICATION

Mask the glazing channels and glass at the intersections as shown. Apply clear silicon to the **inside and outside** of the glass panels. Remove the excess silicon. Remove the masking tape immediately after application.

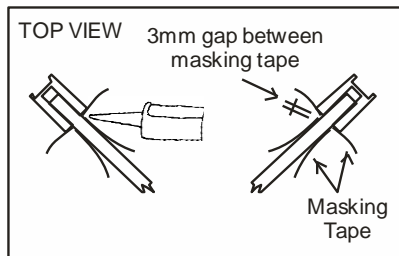

20. INSTALLATION OF BOTTOM DOOR SEAL

Trim to length if necessary. Clip onto the bottom of the door. Ensure the sloping face is inside the shower.

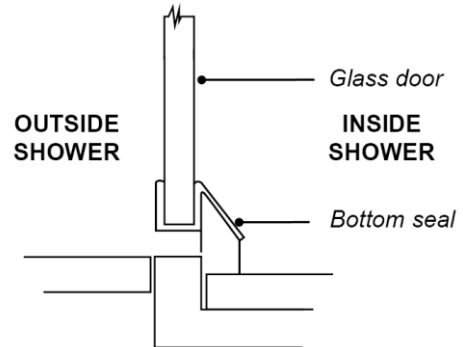

OPTIONAL DOOR SEALS

Two vertical edge seals are supplied with the wall glazing channels. These may be applied to the door opening edges (seals are usually applied to the fixed panels). Seals for the hinged side require being trimmed to fit between the hinges.

Should these seals be required, it is recommended to install them while installing the glass and hinges.



Glacier Hinged Shower System

GLASS RECEIVER CHANNELS MUST BE INSTALLED ONTO THE WATERPROOFING BEFORE THE WALLS ARE TILED.

INSTRUCTIONS FOR 3 WALL SYSTEM

1. Choose door direction.

Left or Right Hand

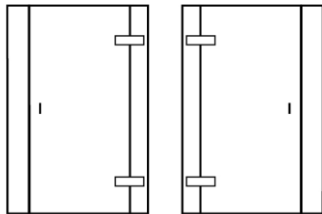

2. Position the glass receiver channels over the base glazing channels. Use a straight edge and mark wall to indicate where the glass receiver channel is plumb.

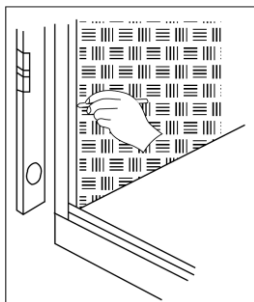

3. Mask two sides of wall channel before applying silicon. Apply a silicon seal to full length of channel. Silicon used must be compatible with anodised aluminium as well as the waterproofing used.

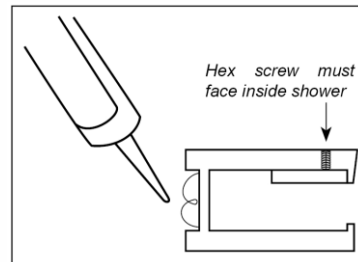

4. Ensure the glass receiver channels are located firmly over the base glazing channels. The machine recess in the wall glazing channel must firmly locate over the base glazing channel. Locate the framing timber. Use the 4mm drill bit to drill holes through the glass receiver channels. Fix four screws through the channels into the wall framing (use wall plugs if required).

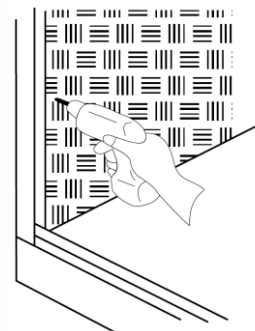



Glacier Hinged Shower System

Apply a 10mm continuous bead of Sika Artic White silicon, to the full length of each wall channel. Silicon seal the join where the wall and base channel will intersect.

TILED WALLS - apply an additional bead of silicon to the inside of the waterproofing

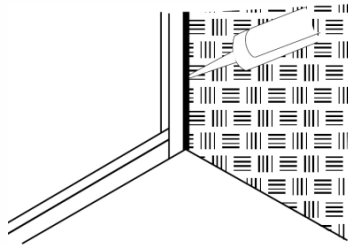

ELLURE WALLS / ACRYLIC LINER - apply an additional bead of silicon to the outside of the acrylic liner.

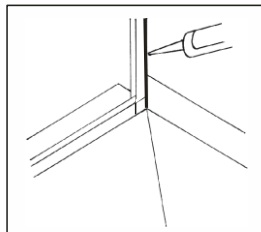

5. THIS STEP ONLY APPLIES IF ACRYLIC LINER HAS BEEN SUPPLIED.

Fix liner cover to wall channel covering exposed liner edge as shown.

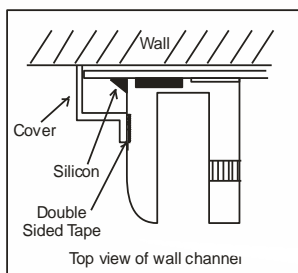

GLASS INSTALLATION

Keep glass standing upright. Once package containing glass is opened, check glass is facing same direction up as label, do not sit glass directly on floor, always sit glass on polystyrene packaging or similar padded surface. Keep glass level with floor to avoid hitting corners on hard surfaces.

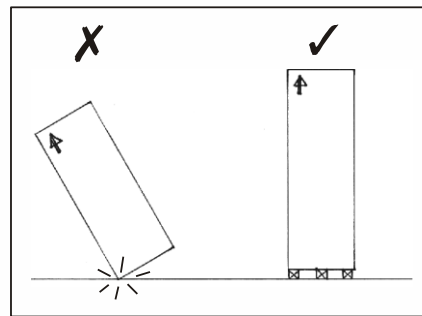

6. PREPARATION FOR GLASS INSTALLATION

Slide the sill infill into position to suit side glass panels. Apply 6mm (**BAG 11**) plastic packers into the base glazing channels in locations as shown.

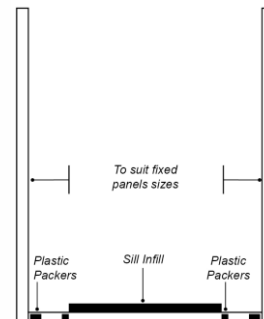



Glacier Hinged Shower System

7. CRITICAL SEAL

Remove dust and dirt first. Seal the connection between the glass receiver channel and the base glazing channel with clear silicon, prior to the installation of panels **B** and **C**. Ensure junction between wall channel and base channel is full of silicon before final glass placement.

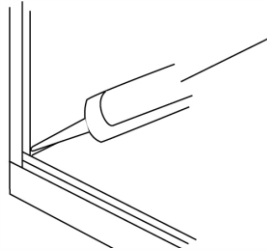

8. INSTALLATION OF RETURN PANEL

Locate the glass panels **B** and **C** into the glazing channels. The top of the panels should align to the top of the glass receiver channels. Add or remove packers in the base glazing channel as necessary for glass height alignment.

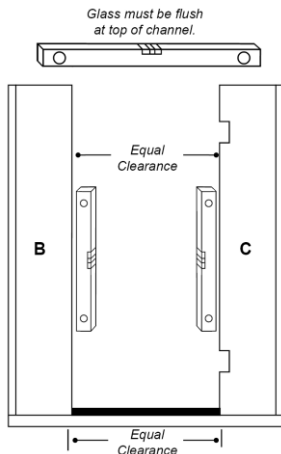

9. SILL INFILL

Apply a continuous bead of clear silicon to each inside face of the base channel. Ensure the ends of the infill are sealed and place into the base channel in the location as shown.

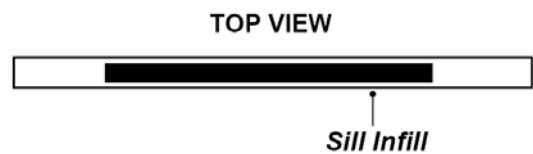

10. FASTENING GLASS

Secure the glass panels into the receiver channels by tightening hex key screws firmly with hex key supplied. **DO NOT OVERTIGHTEN.**

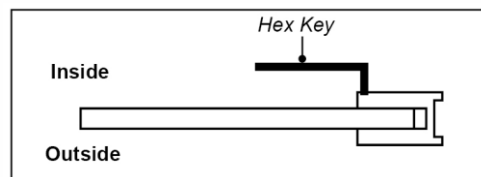

11. PROTECTION OF GLASS EDGE

Apply 1mm plastic packer to edge of glass with masking tape as shown. Position one next to each hinge cut out. **This will ensure correct door clearance and prevent glass damage).**

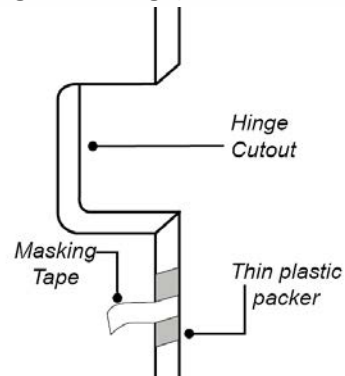



Glacier Hinged Shower System

12. CLEARANCE UNDER DOOR

Place 6mm Spacers over the door infill before the installation of the glass door.

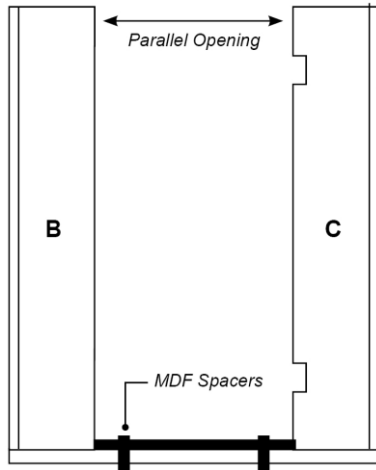

13. HINGE INSTALLATION

Atlantis glass is now coated with CristalCote glass protection at the factory. This coating may cause the hinge to slip after installation. Atlantis recommends cleaning around the hinge cut out prior to fitting hinges. Clean both sides of the glass 15mm around the edge of the cut out with Fuelite (fuelite is available from petrol stations). Alternatively, the area can be lightly sanded with 300grit sandpaper.

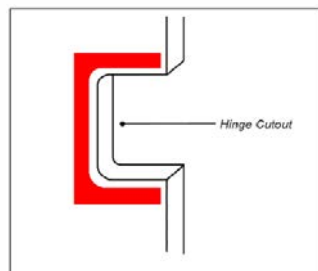

14. ADJUSTABLE HINGES

Atlantis showers are now supplied with adjustable hinges

COVER PLATE REMOVAL

Remove the cover plate with the small grub screw on the top of the hinge cover using 1.5mm key. Loosen the bolts with 4mm hex key.

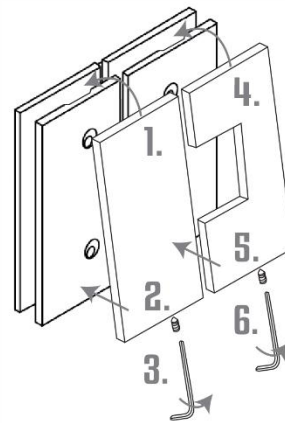

15. DOOR INSTALLATION

Hinges should be in the closed position (in line) before attempting to install the glass door.

Slide the door into the hinges. Centre the door between the side panels and tighten the hinge bolts firmly with the 4mm hex key supplied.

ENSURE HINGES ARE CLEAR FROM SIDES OF GLASS CUTOUTS AND HINGE BOLTS ARE FINALLY TIGHTENED AS MUCH AS POSSIBLE.

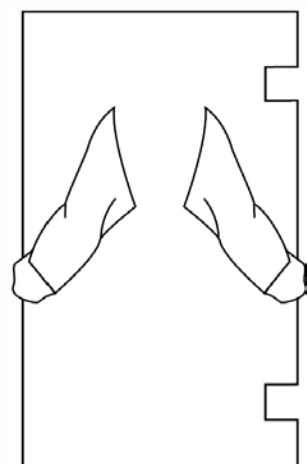



Glacier Hinged Shower System

REFIT COVER PLATE

Ensure bolt heads are on the outside of the shower. Fit to glass and tighten until you hear a squeaking you sound. Refit cover plate with 1.5mm hex key.

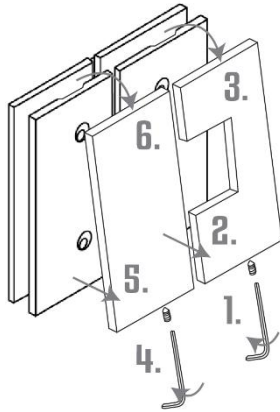

DOOR REALIGNMENT

Use 3mm key on the cap screws near the pivot to loosen the screws, align the door to desired position and then tighten. This will set the new 0 degree point.

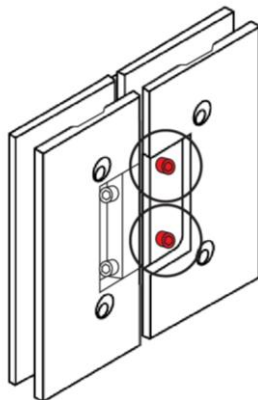

17. DOOR CLEARANCE

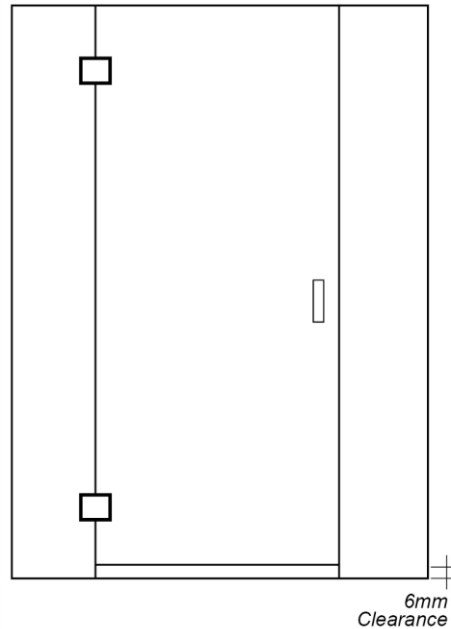

This is the general layout of the correctly aligned screens.

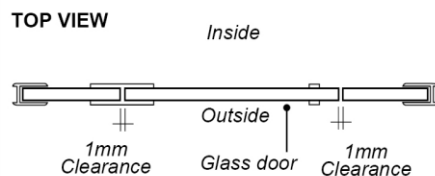

16. HANDLE INSTALLATION

Assemble the handles as shown.

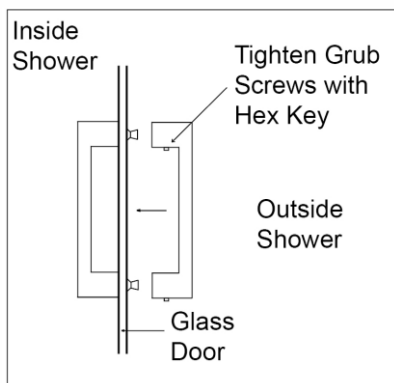

18. METAL TOP BRACE INSTALLATION

Fit 2,3 or 4 top brace blocks to the top brace bar at your discretion. Atlantis suggests that two top brace blocks are fitted for any panel measuring wider than 230mm.

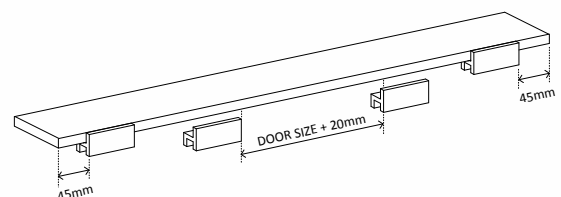



Glacier Hinged Shower System

19. TOP BRACE ASSEMBLY AND INSTALLATION

Place the Top Brace onto the fixed glass panels as shown. Lightly tighten the grub screws onto the glass panels.

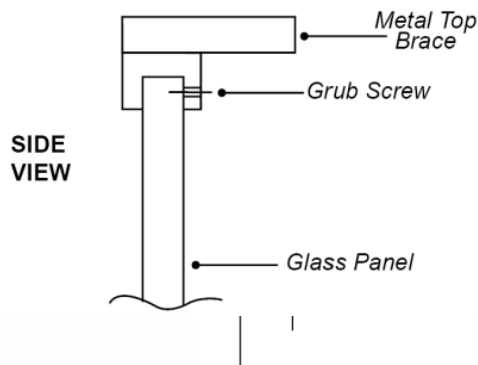

21. INSTALLATION OF BOTTOM DOOR SEAL

Trim to length if necessary. Clip onto the bottom of the door. Ensure the sloping face is inside the shower.

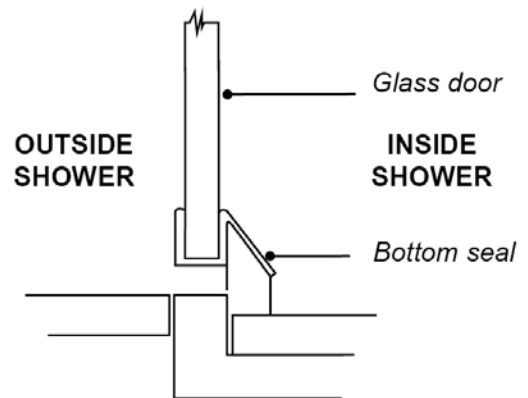

20. SILICON APPLICATION

Mask the glazing channel and glass at the intersections as shown. Apply clear silicon to the inside and outside of the base and wall receiver channels. Remove the excess silicon. Remove the masking tape immediately after application.

