



Milli Inox Extended Basin Mixer (5*)

INSTALLATION INSTRUCTIONS:

NOTE: All mixers should be installed with Isolating Stop Cocks. Arco brand is recommended.

1. Cut a mounting hole 35mm in diameter
2. Screw the two threaded studs into mixer base
3. Position the mixer over the mounting hole. Feed the hoses through the mounting hole
4. From underneath the bench, fit "C" Gasket and "C" Washer over both holes and the threaded studs
5. Screw on long nut and fasten firmly with a Tube Spanner to secure the mixer
6. Connect the water supply:
 - Red Marking Hose to Hot Water
 - Blue Marking Hose to Cold Water
7. Turn on the water supply and check for leaks

WATER SUPPLY REQUIREMENTS:

To ensure optimum performance and customer satisfaction please adhere to the following:

- If the water pressure exceeds or is likely to exceed 500kPa, an approved pressure limiting valve must be fitted
- Flush out all pipe work prior to installation
- If the water temperature exceeds 50°C, an approved tempering valve must be fitted
- Installation should comply with Australian standard AS/NZS 3500 or relevant local authority requirements

CLEANING RECOMMENDATIONS:

We recommend the use of soapy water or approved cleaners. This product should not be cleaned with abrasive materials. Damage caused by any improper treatment is not covered by the product warranty. Refer to Warranty Conditions

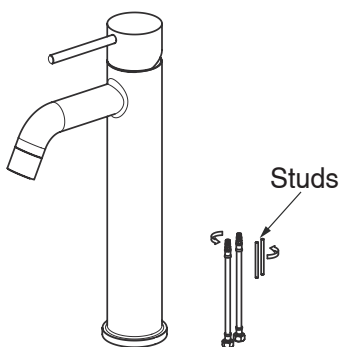

Comes with pre fitted hoses

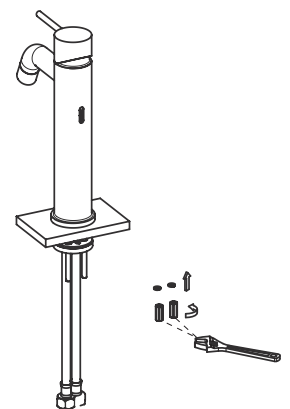
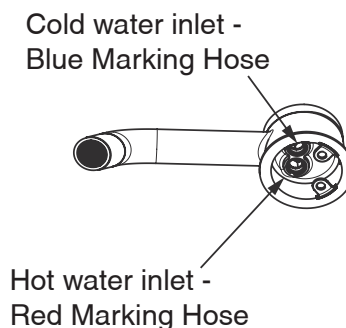

Plumbers, please ensure a copy of the Installation Instructions are left with the end user for future reference