

ISSY

Halo I Vanity Unit



SPECIFICATIONS

| | |
|--|--|
| Recommended Use | Domestic, Hotel & Commercial |
| Vanity Cabinet Material | American Oak veneer (19mm) |
| Vanity Frame Material | 2 Pack Polyurethane on High Moisture Resistant MDF |
| Door Design | Touch release/ Soft close door/s with hinged opening |
| Benchtop Material | Corian (12mm) |
| Handles Material | 150Dia Corian or Marble |
| Colour Variations (Prices may vary) | Please refer to the Colour, Finish and Material Variations Document on the Website for more information. |
| Fixing | Bolted / Screwed to Wall by a Licensed Trades Person (not included) |
| Basin | Sold Separately, refer to Brochure |
| Tapware | Sold Separately. Compatible with Wall mounted tapware |
| Features | Internal Fixed Shelf |



To see the complete Issy range go to www.reece.com.au/bathrooms

| STANDARD SIZES | H1-VU500 | H1-VU600 | H1-VU1000 | H1-VU1200 | H1-VU1500 | H1-VU1800 |
|------------------------|----------|----------|-----------|-----------|-----------|-----------|
| Width (mm) | 500 | 600 | 1000 | 1200 | 1500 | 1800 |
| Depth (mm) | 450 | 450 | 450 | 450 | 450 | 450 |
| Height (mm) | 450 | 450 | 450 | 450 | 450 | 450 |
| Number of Doors | 1 | 2 | 2 | 2 | 4 | 4 |
| Basin Options | 1 | 1 | 1 | 1 | 1-2 | 1-2 |

| CUSTOM SIZES | H1-VU501-600 | H1-VU601-800 | H1-VU801-1100 | H1-VU1101-1300 | H1-VU1301-1600 | H1-VU1601-1800 | H1-VU1801-2000 |
|------------------------|--------------|--------------|---------------|----------------|----------------|----------------|----------------|
| Width (mm) | 501-601 | 601-800 | 801-1100 | 1101-1300 | 1301-1500 | 1601-1800 | 1801-2000 |
| Depth (mm) | 400-500 | 400-500 | 400-500 | 400-500 | 400-500 | 400-500 | 400-500 |
| Height (mm) | 450 | 450 | 450 | 450 | 450 | 450 | 450 |
| Number of Doors | 1 | 2 | 2 | 2 | 4 | 4 | 4 |
| Basin Options | 1 | 1 | 1 | 1 | 1-2 | 1-2 | 1-2 |

Disclaimer: Products in this specification manual must by regulation be installed by licensed and registered trade people. The manufacturer/distributor reserves the right to vary specifications or delete models from their range without prior notification. Dimensions are nominal measurements only. Dimensions and set-outs listed are correct at time of publication however the manufacturer/distributor takes no responsibility for printing errors.

Published 16/02/2024

reece™

ISSY

Halo I Vanity Unit

STANDARD SIZES
TOUCH RELEASE DOOR/S OPENING

500mm

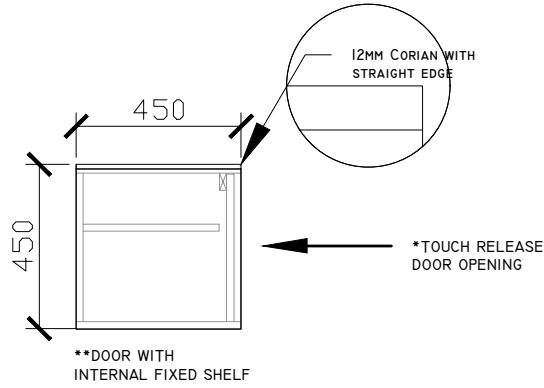
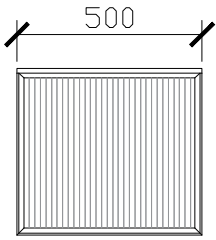

SIDE VIEW for all sizes

600mm

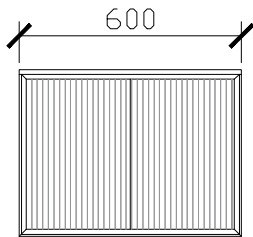

1000mm

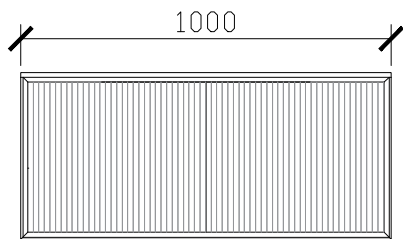

1200mm

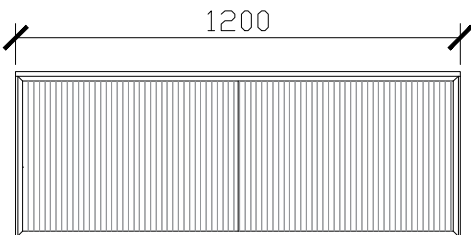

ISSY

Halo I Vanity Unit

STANDARD SIZES
TOUCH RELEASE DOOR/S OPENING

1500mm

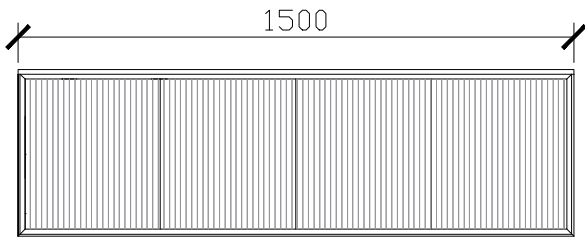

1800mm

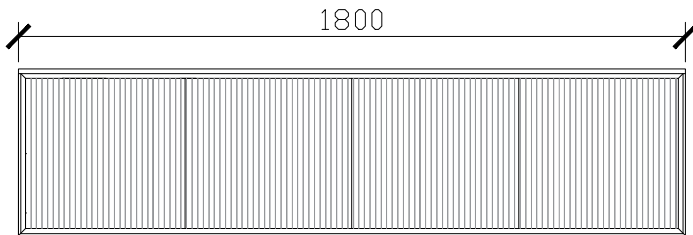

ISSY

Halo I Vanity Unit

CUSTOM SIZES
TOUCH RELEASE DOOR/S OPENING

501-600mm

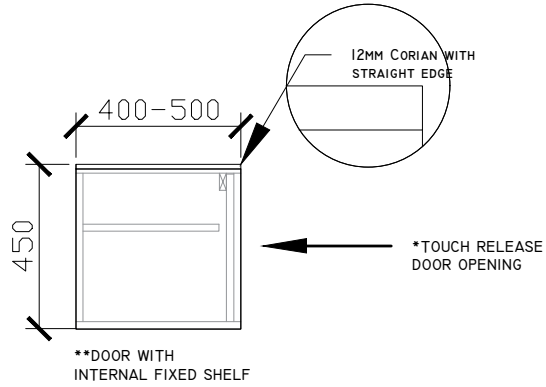
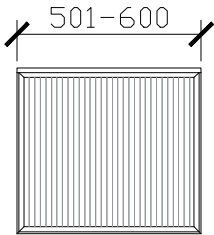

601-800mm

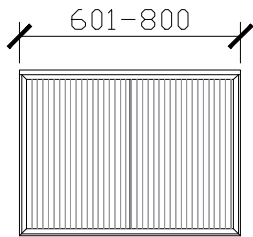

SIDE VIEW for all sizes

801-1100mm

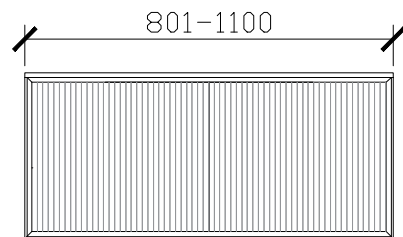

1101-1300mm

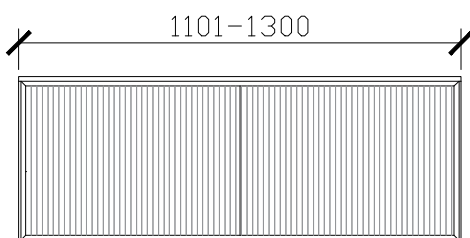

ISSY

Halo I Vanity Unit

CUSTOM SIZES
TOUCH RELEASE DOOR/S OPENING

1301-1600mm

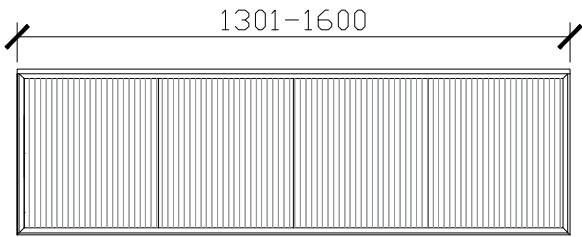

1601-1800mm

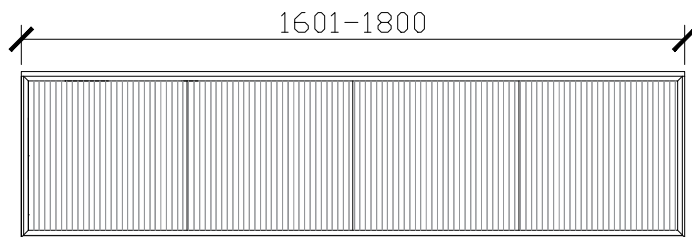

1801-2000mm

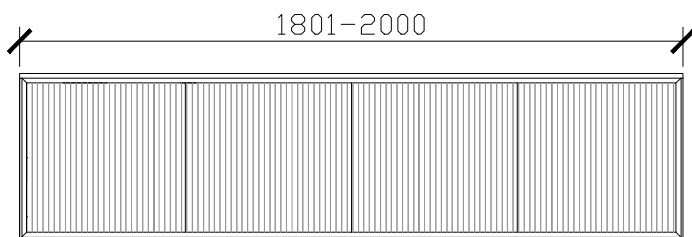

ISSY

Halo I Vanity Unit

STANDARD SIZES
150DIA HANDLE/S OPENING WITH SOFT CLOSE HINGE

500mm

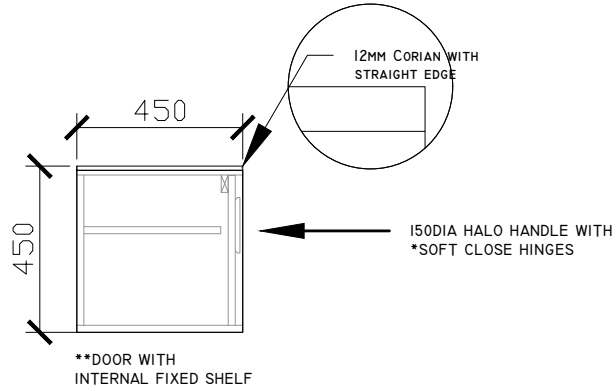
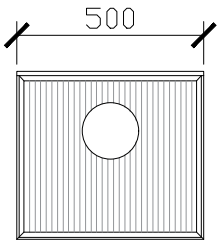

SIDE VIEW for all sizes

600mm

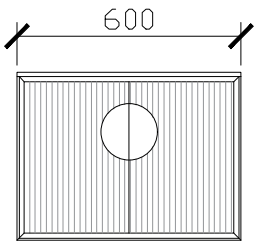

1000mm

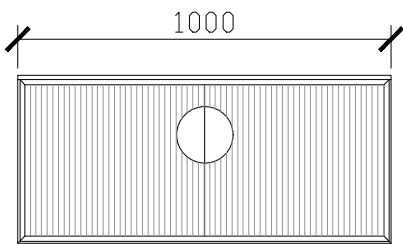

1200mm

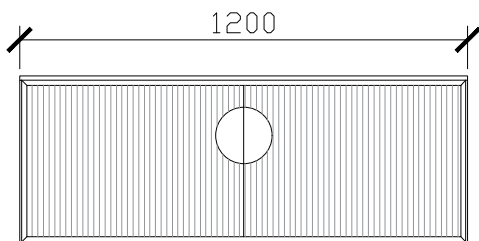

ISSY

Halo I Vanity Unit

STANDARD SIZES
150DIA HANDLE/S OPENING WITH SOFT CLOSE HINGE

1500mm

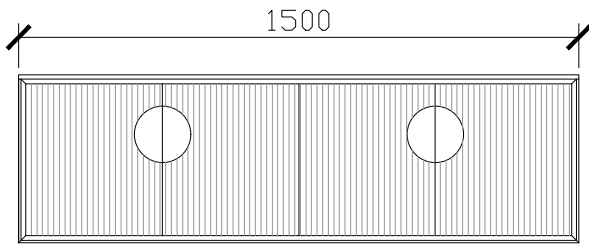

1800mm

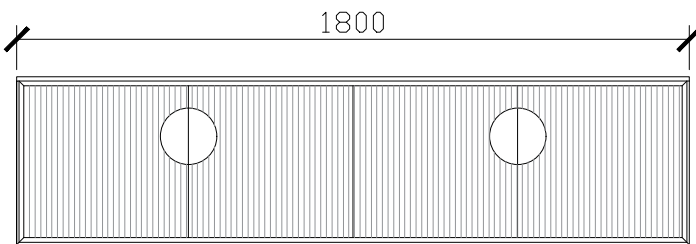

ISSY

Halo I Vanity Unit

CUSTOM SIZES
150DIA HANDLE/S OPENING WITH SOFT CLOSE HINGE

501-600mm

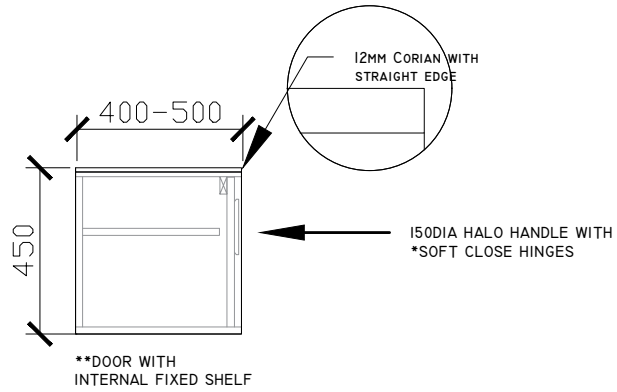
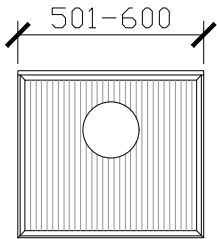

SIDE VIEW for all sizes

601-800mm

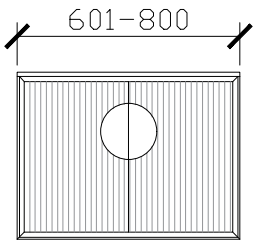

801-1100mm

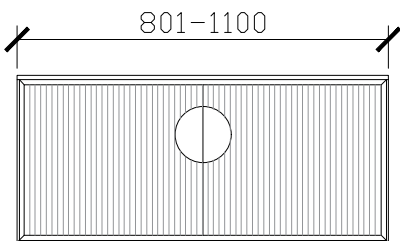

1101-1300mm

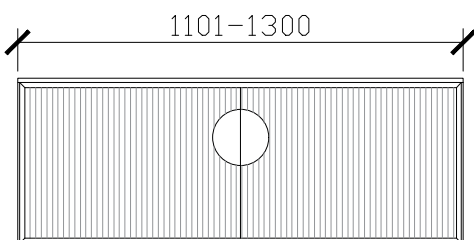

ISSY

Halo I Vanity Unit

CUSTOM SIZES
150DIA HANDLE/S OPENING WITH SOFT CLOSE HINGE

1301-1600mm

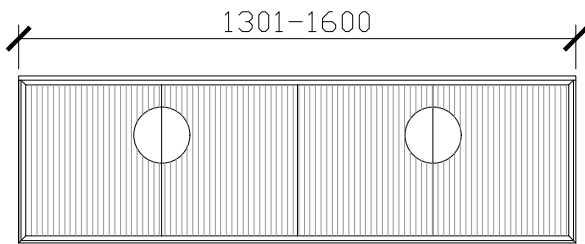

1601-1800mm

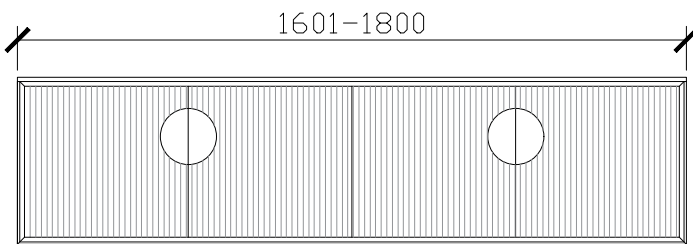

1801-2000mm

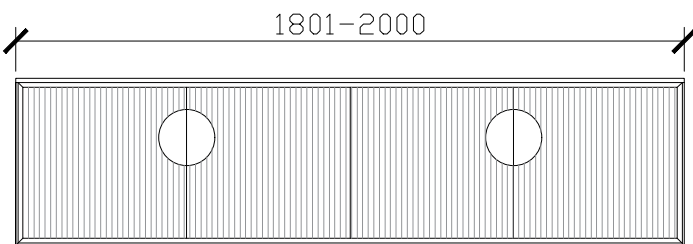

ISSY

Halo I Vanity Unit

STANDARD - RECOMMENDED FOR COUNTER BASINS
120DIA CORIAN CUTOUT

500 - 600W: CENTRAL ONLY

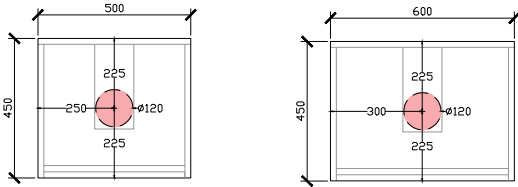

1000W: CENTRAL | OFFSET LEFT & RIGHT

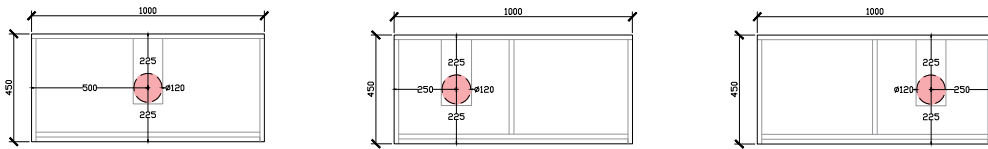

1200W: CENTRAL | OFFSET LEFT & RIGHT

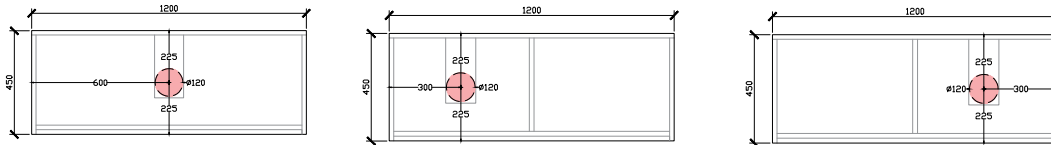

1500W: DOUBLE BASIN | OFFSET LEFT & RIGHT

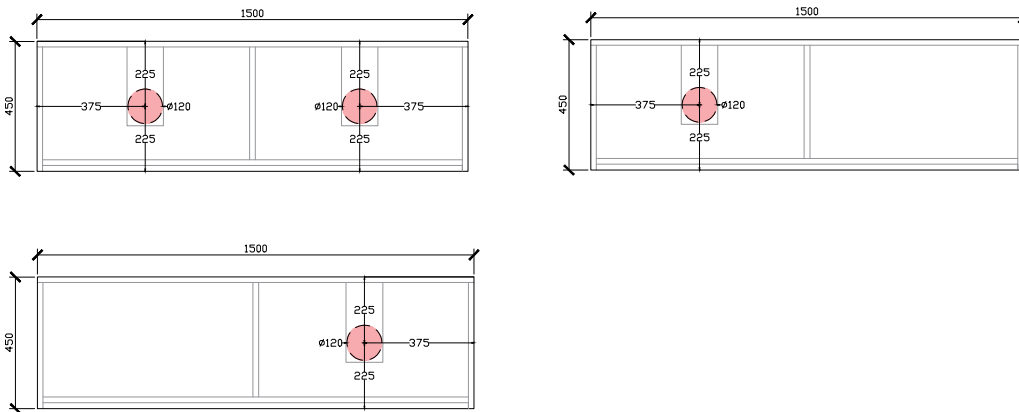

Halo I Vanity Unit

STANDARD - RECOMMENDED FOR COUNTER BASINS
120DIA CORIAN CUTOUT

1800W: DOUBLE BASIN | OFFSET LEFT & RIGHT

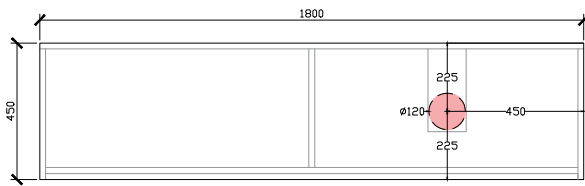
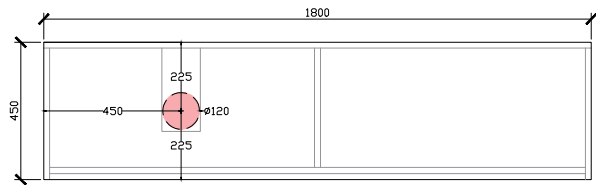
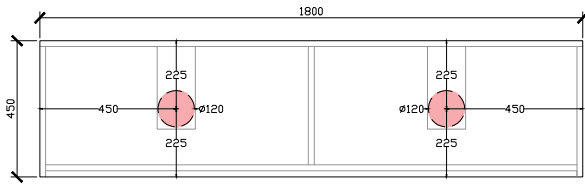

Halo I Vanity Unit

ROCA INSPIRA SOFT SQUARE SEMI-INSET & ROCA INSPIRA ROUND SEMI-INSET
340DIA CORIAN CUTOUT

500 - 600W: CENTRAL ONLY

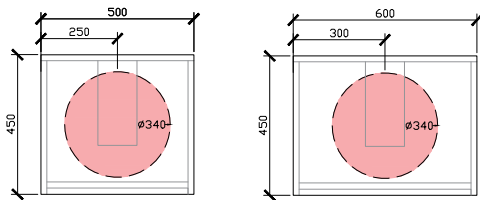

1000W: CENTRAL | OFFSET LEFT & RIGHT

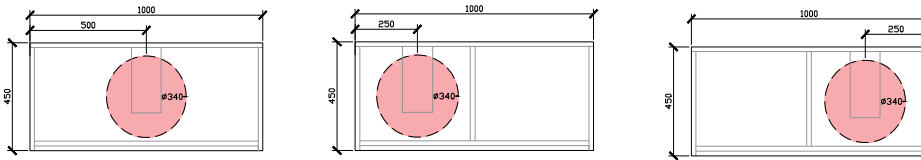

1200W: CENTRAL | OFFSET LEFT & RIGHT

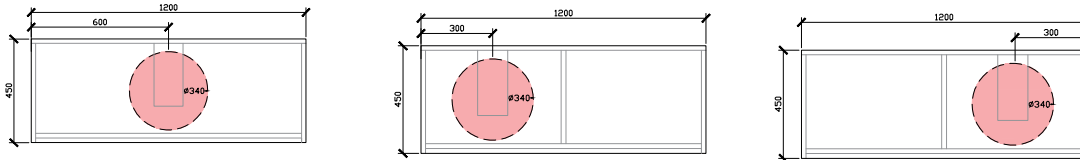

1500W: DOUBLE BASIN | OFFSET LEFT & RIGHT

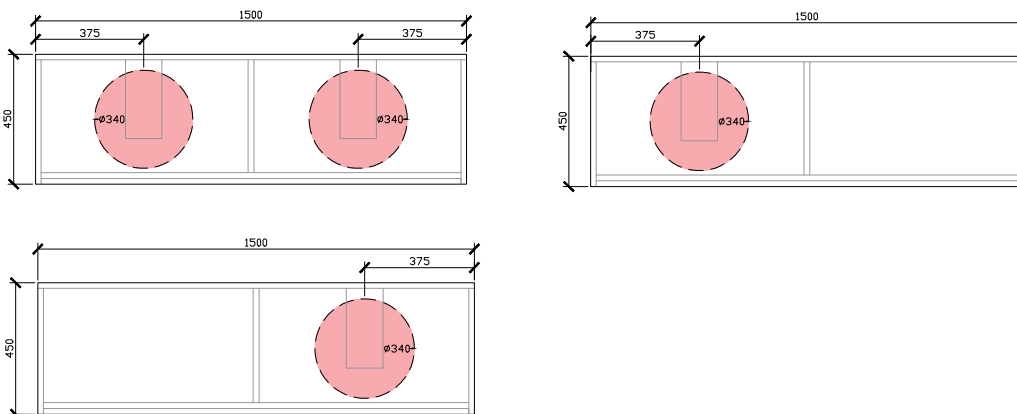

Halo I Vanity Unit

ROCA INSPIRA SOFT SQUARE SEMI-INSET & ROCA INSPIRA ROUND SEMI-INSET
340DIA CORIAN CUTOUT

1800W: DOUBLE BASIN | OFFSET LEFT & RIGHT

